

PLAN

Approx. weight: 125 lbs

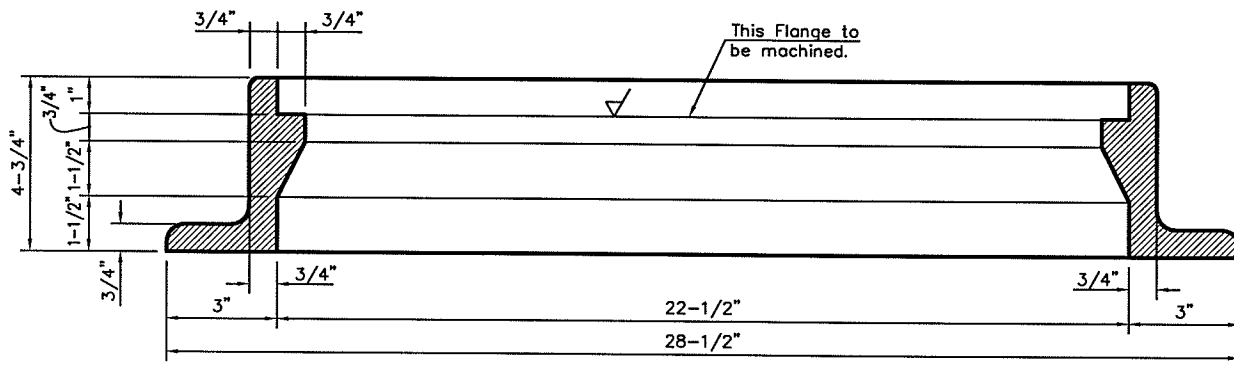

SECTION

STANDARD DIMENSIONS
FOR
**24" CAST IRON
MANHOLE GROUND RIM
MODIFIED HEIGHT TYPE**

**CITY OF
REYNOLDSBURG, OHIO**

STANDARD
CONSTRUCTION DRAWING

Rev.	Date	Dwg. No.
12-18-00	10-09-61	R-9